

## Relocation of the Philipp-Holzmann-School (PHS)

### Project

Enlargement and modification of the American High School to accommodate the PHS Technical School for Building Trade

Client:  
City Frankfurt on the Main,  
represented by the municipal  
building department

### Design Data

Usable main floor space:  
Enlargement 2,730 m<sup>2</sup>  
Modification 8,570 m<sup>2</sup>

Investment: 35 mill.DM  
Incl. equipment: 7 mill.DM

Period of work:  
1995 to 1997

### Services

Brief  
Space utilisation design  
Conceptual and final design  
HVEACS-design  
Furniture & equipment design  
and tendering

Originally the Philip-Holzmann-School in Frankfurt on the Main occupied various buildings all over town. Therefore the aim of the project was to incorporate the school on spot of the previous American High School. In order to do so, the existing buildings had to be assessed with regard to the needs of new space requirements of 39 classrooms and 48 technical job training classrooms/workshops.

Analyses of space program variants led to an economic solution, which could be realised by modifying the existing buildings. Additional space, required for an in-situ training yard was provided in a new building.

Timing constraints forced Frankfurt City authorities to continue the project as „accelerated construction work“. It only took ten months until final planning was ended and fifteen months to finish building and construction work including internal finishes, furniture, fittings and services, room setups, machines and tools.

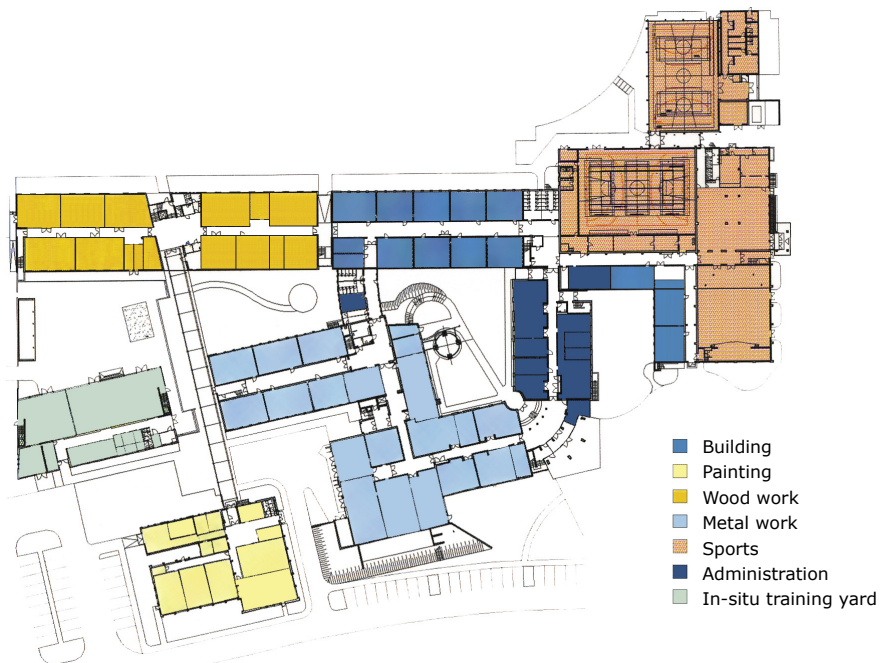

Space use zoning plan of the ground floor

New building of an in-situ training yard

